

# Panasonic

DSS Console and DSS Console for Attendant  
for Digital Super Hybrid Systems

## *Reference Guide*

Model **KX-T7440/KX-T7441**



<KX-T7440>



<KX-T7441>

**Please read this manual before using the DSS Console  
and DSS Console for Attendant.**

*Thank you for purchasing the Panasonic DSS Console  
and DSS Console for Attendant.*

## Contents

Preparation .....	2
Connection .....	2
Location of Controls .....	3
Attaching a Proprietary Telephone .....	3
Wall Mounting .....	4
Caution .....	5

## Preparation

The KX-T7440 Direct Station Selection (DSS) Console and KX-T7441 DSS Console for Attendant can be connected to Digital Super Hybrid Systems (DSHS). This requires a Panasonic Proprietary Telephone (e.g. KX-T7420, KX-T7425, KX-T7431, KX-T7433, KX-T7436) for proper operation.

The DSS Console can work with any Panasonic Proprietary Telephone. The DSS Console and the paired proprietary telephone should be placed next to one another. The DSS Console must be connected directly to the main unit.

Notes: – A standard telephone cannot be used with the DSS Console.  
– In this manual, the suffix of each model number is omitted.

### Accessories

<i>Item</i>	<i>Qty</i>	<i>Order replacement parts no.</i>
Telephone line cord.....	one	PSJA1064Z
Plate.....	one	PSMH1127Z
Screws .....	two	XTW3+S12P

## Connection

Connect as shown.  
For more details, refer to the Installation Manual of the Panasonic Digital Super Hybrid System.

### Attention

Ensure the cords are inserted in the grooves to prevent damage to the connectors, for both wall mounting and desktop positioning.

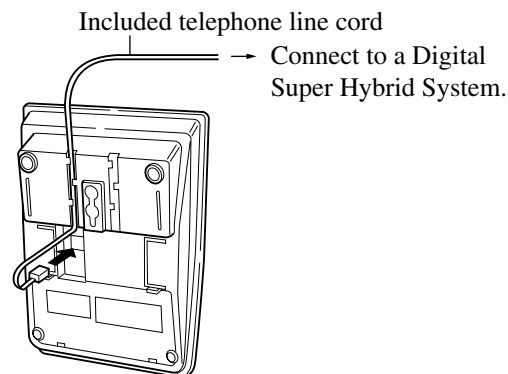

## Location of Controls

### DSS Buttons with Busy Lamp Field (BLF):

The KX-T7440 has 66 DSS buttons and the KX-T7441 has 48 DSS buttons.

To access an extension, simply press a DSS button.

These buttons also can be assigned for one-touch dialing.

The BLF indicates the current status of the corresponding extension.

Off : Idle

Red : Busy

### ■ KX-T7440

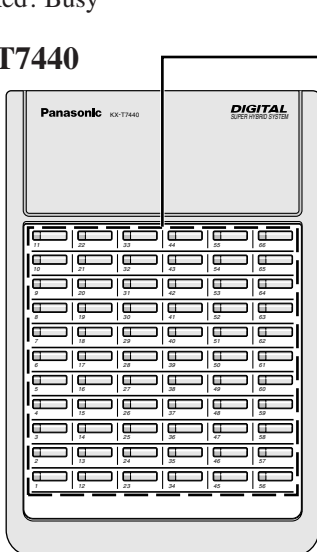

### ■ KX-T7441

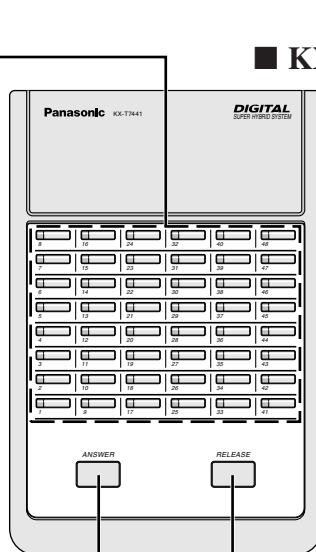

#### ANSWER Button

Used to answer an incoming call.

#### RELEASE Button

Used to disconnect the line.

## Attaching a Proprietary Telephone

This unit can be connected to a Panasonic digital proprietary telephone.

Use the attachment plate and screws.

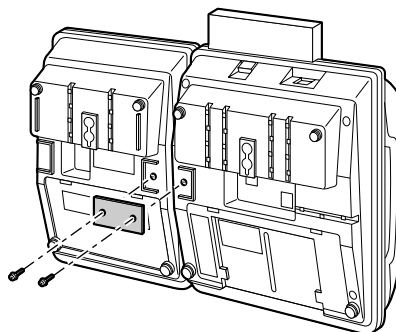

# Wall Mounting

This unit can be mounted on a wall.

**1** Remove the attached stand.

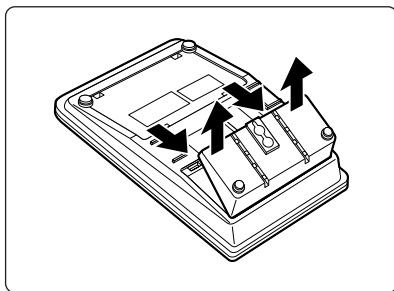

**3** Attach the stand.

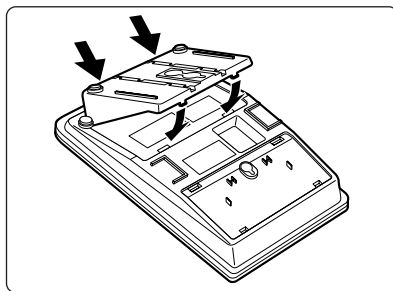

**2** Turn the stand in the opposite direction.

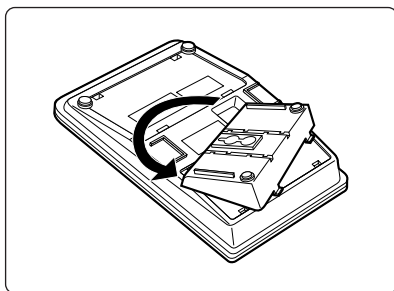

**4** Mount the unit on the wall phone plate.

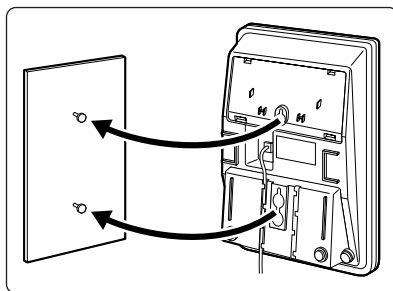

## Caution

### Cautions

- The apparatus is designed to be installed and operated under controlled conditions of ambient temperature and a relative humidity not greater than 60%.
- Avoid installing the apparatus in damp or humid environments, such as bathrooms or swimming pools.
- If the apparatus does not operate properly, disconnect the unit from the extension line cord and then connect again.
- **Power failure transfer**  
Even if the KX-T7440/KX-T7441 are connected to telephone line, they will not operate during a power failure.

### Others:

- If there is any trouble, unplug the extension line and connect a known working phone. If the known working phone operates properly, have the defective phone repaired by one of the specified Panasonic Factory Service Centers. If the known working phone does not operate properly, check the Digital Super Hybrid System and the Internal extension wiring.
- Keep the unit away from heating appliances and electrical noise generating devices such as fluorescent lamps and motors.
- The unit should be kept free of dust, moisture and vibration, and should not be exposed to direct sunlight.
- Do not use benzine, thinner, or the like, or any abrasive powder to clean the cabinet. Wipe it with a soft cloth.

### Warning:

- TO PREVENT FIRE OR SHOCK HAZARD, DO NOT EXPOSE THIS PRODUCT TO RAIN OR ANY TYPE OF MOISTURE.
- This is a Class A Product. In a domestic environment this product may cause radio interference in which case the user may be required to take adequate measures.

This unit complies with the EU Directives.

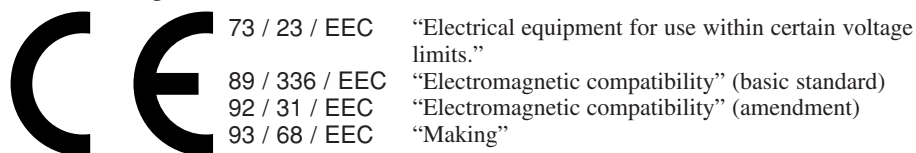

The CE mark on this unit certifies compliance with the above mentioned Directives.



MODEL No. **KX-T7440E**

**For your future reference**

SERIAL NO. \_\_\_\_\_ DATE OF PURCHASE \_\_\_\_\_  
(found on the bottom of the unit)

NAME OF DEALER \_\_\_\_\_

DEALER'S ADDRESS \_\_\_\_\_

**Panasonic Business Systems U.K.**  
Panasonic House, Willoughby Road, Bracknell,  
Berkshire RG12 8FP